



Heilmuth, Obata & Kassabaum, Inc.
124 Giralda Avenue, Suite 100
Coral Gables, FL 33134 USA
t +1 786 539 0800
www.hok.com/studios/miami

Qualifying Agent, Jonathan Rae - FL Reg. No. AR02342

All reproduction & related property rights reserved © 2025
In Association with



THA Consulting, Inc.
Pompano
40 NW 3rd Street, Suite 1102
Miami, FL 33128
T: 305 582 7123
www.tha-consulting.com



Hammond & Associates INC
Mechanical, Fire Protection
499 W. 7th Ave, Suite 215
Pompano, FL 33077
PH: 564-327-7111
www.hammondassociates.com



Kugler Ning Lighting, Inc.
Lighting design
247 West 27th Street Suite 1502
New York, NY 10018
www.kuglerlighting.com



SOCOTEC Life Safety, LLC
Life Safety
1380 W. Peachtree St NW Suite #1010
Atlanta, GA 30309
www.socotec.us



VDA, Inc.
Vertical Transportation
1000 West McAlister Road, Suite 209
Pompano Beach, FL 33069



Brooks Acoustics
Acoustics
48 N. Federal Highway #121
Pompano Beach, FL 33062

NOT FOR
CONSTRUCTION

Professional Seal

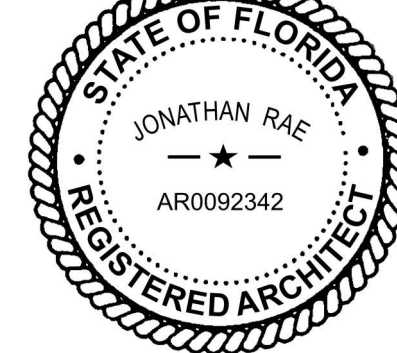

No.	Description	
	100% SCHEMATIC DESIGN	11/21/2025
	50% DESIGN DEVELOPMENT	01/22/2026
	100% DESIGN DEVELOPMENT	03/09/2026
	DRC SUBMISSION	03/11/2026

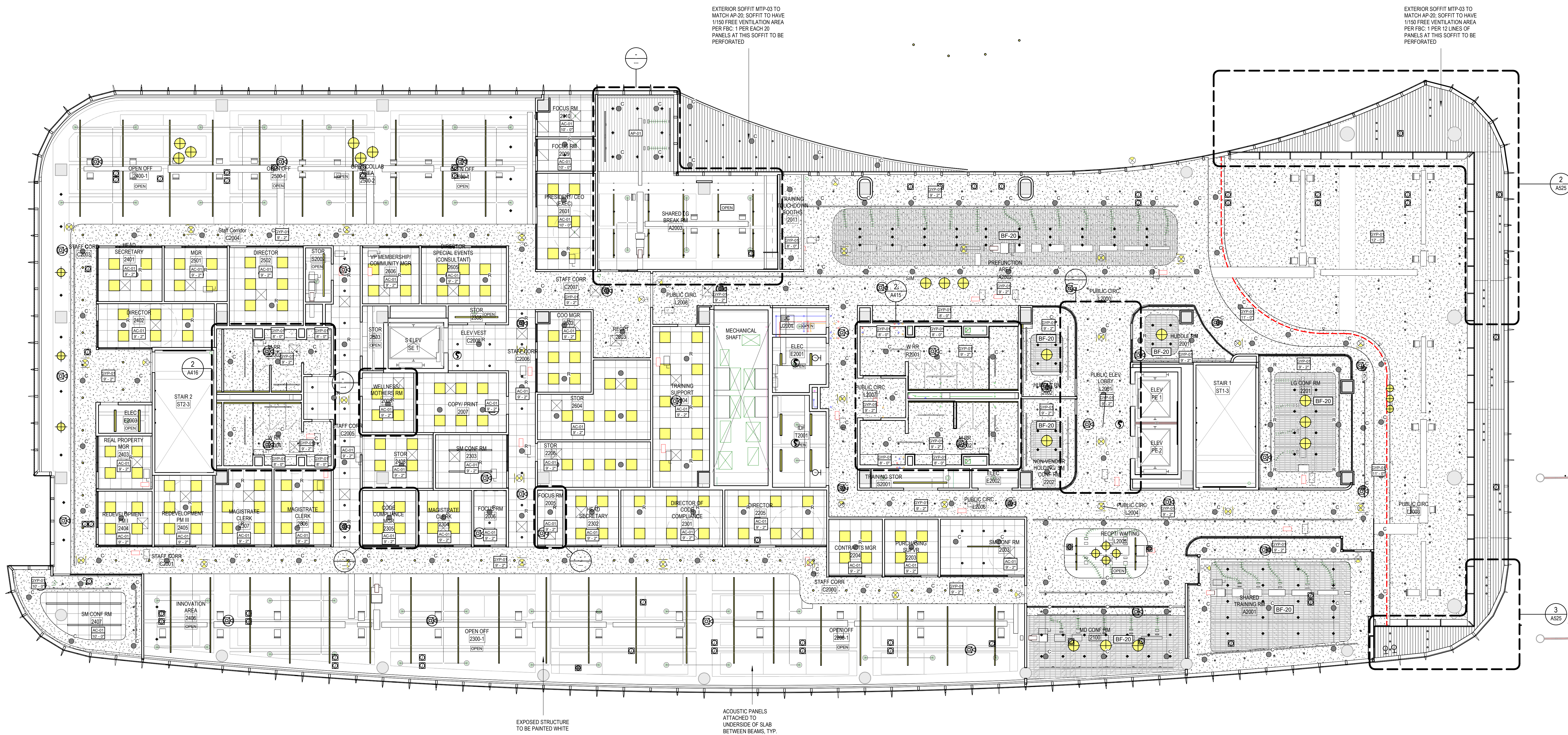

1 REFLECTED CEILING PLAN - LEVEL 2
1/8" = 1'-0"

GENERAL REFLECTED CEILING PLAN NOTES

- SEE TYPICAL DEVICE MOUNTING ELEVATION AT SYMBOLS AND ANNOTATIONS LEGEND SHEET FOR MOUNTING HEIGHTS AND ALIGNMENT REQUIREMENTS FOR WALL-MOUNTED DEVICES.
- VERIFY CEILING HEIGHTS AND CEILING PLUMB/CLEARANCES TO ASSURE FINISHED CEILING HEIGHTS CALLED OUT ON INTERIOR ARCHITECTURE DOCUMENTS CAN BE ACHIEVED. BRING DISCREPANCIES TO ARCHITECT'S ATTENTION PRIOR TO COMMENCEMENT OF WORK.
- WALL-MOUNTED STROBES TO BE LOCATED AT 8" AFF TO VERTICAL CENTERLINE. HORIZONTAL CENTERLINE TO ALIGN WITH ELECTRICAL RECEPTACLE, LIGHT SWITCH OR THERMOSTAT AT SAME PARTITION. SEE ENGINEER'S DRAWINGS FOR LOCATIONS AND SPECIFICATIONS. COORDINATE ALIGNMENTS WITH ARCHITECT ON SITE.
- DETECTION AND NOTIFICATION DEVICES (SUCH AS SMOKE DETECTORS, FIRE STROBES, FIRE HORNS, ANTENNAE) LOCATIONS TO BE COORDINATED BY CONTRACTOR TO ALIGN WITH NEARBY DEVICES OR EQUIPMENT. SUBMIT TO ARCHITECT FOR FINAL ALIGNMENT APPROVAL PRIOR TO ROUGH-IN AND WIRING.
- CONTRACTOR TO COORDINATE FOR ARCHITECT APPROVAL OF DEVICE AND EQUIPMENT LOCATIONS AND ALIGNMENTS TO BE INSTALLED AT GVB CEILINGS. TO INCLUDE, BUT IS NOT LIMITED TO, LOCATIONS OF SLOT DIFFUSERS, SPOT DIFFUSERS, SPRINKLERS, MONITORING DEVICES, NOTIFICATION DEVICES, LIGHT FIXTURES, ANTENNAE, AIR ROUGH-INS, AND SIMILAR ITEMS. TO BE APPROVED PRIOR TO CABLING AND CEILING CLOSING.
- INSTALL SUSPENDED CEILING GRID TO BE LEVEL WITHIN A TOLERANCE OF 1/8" IN 12'-0". CEILING HEIGHTS SHALL BE MEASURED FROM THE HIGH POINT OF PATCHED FLOOR SLAB. CEILING HEIGHTS INDICATED TO BE THE SAME HEIGHT ARE TO ALIGN VERTICALLY FOR FULL PROJECT. COORDINATE WITH FULL HEIGHT DOORS AND PERIMETER SOFFIT CONFIGURATION. CEILING ASSEMBLIES TO BE LATERALLY BRACED.
- CEILING GRIDS TO BE CENTERED IN ROOMS OR SPACES WITH EQUAL PANELS AT OPPOSITE SIDES. UNO.
- GRIDS AT OPPOSITE SIDES OF GLASS WALLS TO ALIGN FROM SIDE-TO-SIDE TO APPEAR AS IF CONTINUOUS. UNO.
- UNDERCABINET LIGHTING TO BE INDEPENDENTLY CONTROLLED AT EACH LOCATION. CONTINUOUS LENGTH OF UNDERCABINET LIGHTING AT SINGLE RUN TO BE CONTROLLED AS ONE.
- ARCHITECTURE REFLECTED CEILING PLANS INDICATE: GENERAL TYPE AND SPECIFIC LOCATIONS OF LIGHT FIXTURES, GENERAL TYPE AND SPECIFIC LOCATIONS OF EXIT SIGNS, AND GENERAL TYPE AND GENERAL LOCATIONS OF AV EQUIPMENT.
- ELECTRICAL ENGINEERING DRAWINGS INDICATE: A) CIRCUITING AND WIRING OF LIGHT FIXTURES AND CONTROLS, B) LIFE SAFETY EQUIPMENT, C) LOCATION OF REQUIRED EMERGENCY LIGHT FIXTURES, AND D) LIGHT FIXTURE SPECIFICATIONS.
- MECHANICAL ENGINEERING DRAWINGS INDICATE: A) DUCTS AND AIR MOVEMENT REQUIREMENTS, AND B) GRILLE AND REGISTER SPECIFICATIONS AND SIZES.

- DESIGN-BUILD FIRE PROTECTION DRAWINGS INDICATE: A) GEOMETRY, LOCATION, AND SIZE OF SPRINKLER LINES; B) SPRINKLER HEAD LOCATIONS IN SPECULATED AREAS ONLY; C) PRESSURE REQUIREMENTS, AND D) SPRINKLER HEAD SPECIFICATIONS.
- WHERE ACOUSTICAL CEILING PANELS OR FLEES ARE REQUIRED TO BE CUT, CUT TO MAINTAIN SHARP, CLEAN AND NEAT EDGE. WHEN CUT EDGE IS EXPOSED TO VIEW AT FINAL INSTALLATION, REFINISH CUT EDGE TO MATCH FACE FINISH OF PANEL OR TILE.
- INSTALL LIGHT FIXTURES, SPRINKLER HEADS, SPOT DIFFUSERS, MONITORING DEVICES, NOTIFICATION DEVICES, ANTENNAE, AND SIMILAR ITEMS CENTERED ON LAY-IN PANELS IN SUSPENDED CEILING AREAS. UNO.
- EMERGENCY LIGHTING AND ILLUMINATED EXIT LIGHTING OR SIGNAGE SHALL BE WIRED TO THE BUILDING'S EMERGENCY WIRING SYSTEM AND KEPT INDEPENDENT OF OTHER WIRING SYSTEMS.
- NO ACCESS PANELS TO OCCUR AT ANY GVB CEILING WITHOUT THE WRITTEN CONSENT OF ARCHITECT. WHEN PRESENT, ACCESS PANEL TO BE CENTERED ON CEILING FEATURES OR ADJACENT DEVICES. TO BE THINNESS GRID-TYPE PANEL WITH TAPED-AND-SPACKLED FRAME EDGE AND NO EXPOSED FASTENERS.
- WHEN MORE THAN ONE OPERATING OR MONITORING DEVICE OR SWITCH OCCURS IN ONE LOCATION, GANG DEVICES TOGETHER AND PROVIDE A COMMON SWITCH PLATE COVER.
- DIMENSIONS ARE TO CENTERLINE OF VISIBLE FIXTURE OR DEVICE. UNO.
- PROVIDE ADDITIONAL CONCEALED FRAMING, BLOCKING, AND ANCHORING ABOVE CEILINGS AS REQUIRED FOR SUPPORT OF CEILING-MOUNTED FIXTURES, EQUIPMENT, OR DEVICES. PROVIDE LATERAL BRACING.
- CONTRACTOR TO COORDINATE COLOR FINISH OF OPERATING, SECURITY, MONITORING, ANTENNAE, SWITCHING DEVICES AND COVER PLATES WITH COLOR OR FINISH WALL OR SURFACE ON TO WHICH THEY ARE MOUNTED. WHEN INSTALLED AT OPEN CEILING AREAS, ITEMS TO BE COORDINATED WITH GENERAL OVERHEAD PAINT COLOR. DEVICES AND COVER PLATES TO BE BLACK AT DARK TONE SURFACES OR AREAS. TO BE GREY AT MEDIUM TONE SURFACES OR AREAS. TO BE BROWN AT WOOD PANEL WALLS OR SURFACES, AND TO BE WHITE ELSEWHERE. COORDINATE WITH INTERIOR ARCHITECT FOR "DARK" AND "MEDIUM" TONE WALL SURFACE, OR AREA FINISH CLASSIFICATIONS. PROVIDE FULL RANGE OF DEVICE AND COVER PLATE FACTORY FINISHES FOR EACH DEVICE TYPE FOR ARCHITECT'S COLOR SELECTION, INCLUDING BLACK, GREY, BROWN AND WHITE.
- SPRINKLERS TO BE FLUSH CONCEALED CONFIGURATION. CONTRACTOR TO COORDINATE COLOR FINISH OF FLUSH SPRINKLER HEAD COVERS WITH COLOR OF SURFACE ON TO WHICH THEY ARE MOUNTED. COVER PLATES TO BE BLACK AT DARK TONE SURFACES, TO BE MIRROR STAINLESS AT MEDIUM TONE SURFACES, TO BE BROWN AT WOOD OR WOOD TONE SURFACES, AND TO BE WHITE ELSEWHERE. COORDINATE WITH INTERIOR ARCHITECT FOR "DARK" AND "MEDIUM" TONE WALL SURFACE, OR AREA FINISH CLASSIFICATIONS. PROVIDE FULL RANGE OF SPRINKLER COVER FACTORY FINISHES FOR ARCHITECT'S COLOR SELECTIONS.

- SUPPLY AND RETURN GRILLES AND DIFFUSERS AT GVB CEILINGS TO BE LINEAR DIFFUSERS TO ALIGN WITH ADJACENT LIGHT FIXTURES OR CEILING FEATURES. PROVIDE DUMMY GRILLES AS REQUIRED TO YIELD CONTINUOUS APPEARANCE. FINISH INSIDE OF ACTIVE AND DUMMY GRILLES AND ANY DUCTWORK OR FRAMING IN VIEW FROM BELOW MATTE BLACK. FINAL LOCATIONS, LENGTHS, AND ALIGNMENTS TO BE REVIEWED WITH INTERIOR ARCHITECT PRIOR TO FINAL FRAMING.
- AT CEILING ASSEMBLIES WITH A FINISH OTHER THAN WHITE, HVAC DIFFUSERS, GRILLES, AND ACCESS PANELS TO BE CUSTOM FINISHED TO FULLY MATCH FACE FINISH OF CEILING.
- IN ADDITION TO QUANTITY OF EXIT SIGNS SHOWN ON PLANS, PROVIDE FOR TEN PERCENT, BUT NO FEWER THAN FIVE (5), ADDITIONAL ILLUMINATED EXIT SIGNS PER FLOOR TO BE INSTALLED OR RELOCATED ON SITE AT THE DIRECTION OF ARCHITECT OR LOCAL JURISDICTIONAL INSPECTOR(S). TO MATCH PROJECT TYPICAL INTERNALLY ILLUMINATED EXIT SIGN AND MOUNTING FOR EACH LOCATION TYPE.
- WALL-MOUNTED FIRE STROBES OR HORNS HOUSINGS TO BE WHITE. CEILING-MOUNTED FIRE STROBES OR HORNS HOUSINGS TO BE WHITE.
- ARCHITECTURAL REFLECTED CEILING PLANS INDICATE: GENERAL TYPE AND SPECIFIC LOCATION OF LIGHT FIXTURES OF SIGNAL EQUIPMENT DEVICES, SPRINKLER AREAS, ELECTRIC ENGINEERING DRAWINGS INDICATE:
A. CIRCUITING AND WIRING OF LIGHT FIXTURES AND SWITCHES
B. LIFE SAFETY EQUIPMENT
C. LOCATION OF REQUIRED EMERGENCY LIGHT FIXTURES
D. LIGHT FIXTURE SPECIFICATIONS
- REFER TO MECHANICAL DRAWINGS FOR ACCESS PANEL LOCATIONS AT HARD CEILINGS. OBTAIN ARCHITECT'S REVIEW AND APPROVAL PRIOR TO INSTALLATION.

REFLECTED CEILING PLAN LEGEND

MATERIALS	LIGHT FIXTURES	ANNOTATIONS	MECHANICAL REGISTERS
ACT-20 2" x 2" GRID AND TILE SYSTEM	2" x 2" RECESSED	AC-1 10'-0"	2" x 2" SUPPLY DIFFUSER
ACT-21 TEXTURE CEILING PANELS	2" x 4" LENSED LED FIXTURE	C CENTERLINE SYMBOL	2" x 2" RETURN DIFFUSER
OPEN OPEN TO STRUCTURE ABOVE WITH ACOUSTIC PANELING APPLIED TO UNDERSIDE OF DECK	RECESSED LINEAR WALLWASH	ALIGN ALIGN SYMBOL	ACCESS PANEL
GYP-21 GYPSUM BOARD CEILING	RECESSED LINEAR	LOCATIONS OF ROLLER SHADE, REFER TO KEYNOTES & SPECIFICATIONS FOR DETAILS	LINEAR RETURN SUPPLY DIFFUSER
AP-20 LONGBOARD WOOD-LOOK ALUMINUM TONGUE AND GROOVE PLANKS	RECESSED DOWNLIGHT		LINEAR RETURN SUPPLY DIFFUSER (PLACED ON SOFFIT)
BF-20 ACOUSTIC PET BAFFLE CEILING	RECESSED WALL WASH DOWNLIGHT		
MTL-20 METAL MESH CEILING SYSTEM	SEMI RECESS WALLWASH		
	SURFACE MOUNTED STRIP LIGHT		
	WALL SCONCE		
	PENDANT MOUNTED LINEAR		
	DECORATIVE PENDANT		
	COVE UPLIGHT STRIP		
	PENDANT LINEAR TRACK		
	PENDANT CYLINDER DOWNLIGHTS		
	UNDER CABINET		
	UPLIGHT STRIP		
	FLEXIBLE LINEAR STRIP LIGHT		
	WALL MOUNTED LINEAR LIGHT		

PZ26-12000002
05/27/2026

Original: 48" x 36" 1/4" scale contents of this drawing
Sheet Number